

Interface *Hospitality*

HAMPTON INN BY HILTON

Approved Prototypes

Hampton Inn By Hilton
Hilton Garden Inn
Home 2 Suites
Tru By Hilton

Why **Interface® Hospitality**?

Interface Hospitality is a **Hilton** approved supplier of carpet tile and LVT. We are currently on the following prototypes:

- Hampton Inn by Hilton
- Hilton Garden Inn
- Home 2 Suites
- Tru By Hilton

1. **8 WEEKS OR LESS LEAD TIME** for anything not already in stock.
2. **NO ROLL SIZES OR WIDTHS** to deal with. We come in boxes!
3. What about **UNIT COST?** We can compare the real cost of tile vs. broadloom for each project and show you the true savings.
4. **15 YEAR WARRANTY.** Say no more.
5. **SELECTIVE REPLACEMENT** means little to no disruptions to hotel operations.
6. **INTERSEPT®** antimicrobial protection. Keepin' it clean.
7. **PROTEKT²** stain resistant technology. Keepin' it real clean!
8. Greater **EASE OF HANDLING**, less liability related to mis-cutting of broadloom.
9. Order and installation is a breeze with our **ESTIMATES, SEAMING DIAGRAMS, AND RENDERINGS.**
10. All of our yarns are **100% SOLUTION-DYED NYLON.**
11. **VARIOUS TILE SIZES** make is easier to design/define spaces and sub-spaces.
12. Our **CARPET** and **LVT** work together in seamless integration, with no transition strips.
13. We are **MORE SUSTAINABLE:** All of our products are **EPD** verified.
14. Interface Hospitality's **REENTRY® RECLAMATION & RECYCLING** program results in our products having up to 80% recycled content, from returned/used carpet.
15. We are the first global manufacturer to declare that all our products globally – including all carpet and luxury vinyl tile (LVT) – are **CARBON NEUTRAL** across their entire product lifecycle.

Why **Interface® Hospitality**?

1. **Lead Time**

If not in stock, our lead times are 6-8 weeks and all products are manufactured in the USA. FOB Union City, Georgia.

2. **No Roll Sizes or Widths**

There are no widths and roll sizes to deal with, which can often lead to hidden costs and unused material.

3. **Unit Cost**

The unit cost is only part of the evaluation when comparing carpet tile to broadloom for your hotel. Waste is a big consideration with total project cost. We can develop project specific ROI's to compare total project cost for your individual property.

4. **15 Year Warranty**

All Interface Hospitality products are hard wearing, provide lasting protection against excessive surface wear, edge ravel, backing separation, shrinking, stretching and permanent soiling and staining.

5. **Selective Replacement**

Whether you're replacing a single guest room, a corridor, or an entire hotel, you can do so without disruption. Interface Hospitality's selective replacement enables old flooring to be replaced quickly and efficiently any day of the week, your carpet replacement costs can be cut by up to 50%.

6. **Intersept®**

Mold Protection no matter what's spilled on the floor, our proprietary antimicrobial preservative, Intersept®, protects our modular carpet against the growth of odor-causing bacteria guaranteed. With proper maintenance, Intersept treated carpet safely and effectively inhibits the growth of mold and other bacteria so your floors are always fresh. All Interface carpet is standard with Intersept.

7. **Protekt²**

Because stain resist technology - Protekt² - is built into Interface carpet tiles, a topical stain resist treatment is not necessary. The additional polymer is included when nylon is manufactured so it permanently increases stain resistance. We conducted stain tests on our products and compared them to products with a topical treatment. The results? Our uncoated fibers performed just as well as the treated ones. Additionally, the fluorinated chemicals traditionally used in stain resist treatments, when they do wash off, persist in the environment for thousands of years. With Protekt², you get permanent stain resistance, not permanent pollution.

8. **Ease of Handling**

Carpet tile offers greater ease of handling, and installers have less liability related to possible mis-cutting of broadloom.

9. **Installation**

Order and installation is a breeze with our estimates, seaming diagrams and renderings.

10. **100% Solution-dyed Nylon**

Vibrant color that does not fade. All Interface Hospitality carpet tiles are made from durable, stain resistant, 100% solution dyed nylon. Offering superior color fastness and a wide array of colors and textures, solution dyed nylon is less harmful to the environment, using no water or toxic chemicals in the manufacturing process.

11. **Various Sizes**

Using, 50cm, 1m, 25cm x 1m and 50cm x 1m tiles allows for optimal pattern repeats, asymmetrical and symmetrical designs and color use. It also allows design to define Spaces / Nesting within larger areas.

12. **Integrated System**

Interface modular tiles span a wide selection of designs that offer pattern, color and texture options for a myriad of flooring needs. Tiles come in a variety of shape and size modules that work seamlessly and interchangeably with each other. This compatibility allows for holistic flooring solutions with expansive design flexibility.

13. **Sustainable Choice**

Environmental Responsibility. Interface Hospitality was the industry's first to earn an EPD (Environmental Product Declaration), which evaluates consistent factors based on full lifecycle assessment (LCA). We now have published EPDs for 99% of our products globally. In addition, all of our products with GlasBac®, GlasBacRE and NexStep® backings meet NSF/ANSI 140 Sustainable Carpet Assessment Standard (SCAS) for carpet.

14. **Carpet Recycling Program: ReEntry®**

Recyclable is Now a Reality. Through our ReEntry program and partnerships with our fiber suppliers and recycling centers throughout North America, separated Type 6 and 6,6 nylon are recycled into new 6 and 6,6 nylon, while separated GlasBac® and similar competitor backings are recycled into GlasBac®RE non-virgin PVC backing using our Cool Blue™ technology. The result? Products with up to 80% total recycled content, including as much as 35% post-consumer content.

15. **Carbon Neutral**

We are the first global manufacturer to declare that all our products globally — including all carpet and luxury vinyl tile (LVT) — are carbon neutral across their entire product lifecycle. We've achieved carbon neutrality by drastically reducing our carbon footprint and addressing the rest of our emissions through carbon offset investments.

16. **Dimensional Stability**

Interface GlasBac® backing has been tested and proven in the marketplace for over 30 years. Engineered to provide superior dimensional stability, GlasBac® modular carpet tiles will not stretch or shrink when exposed to heat or cold, heavy foot or rolling traffic.

17. **Sound Absorption**

Quiet space is essential when people need to focus and concentrate. Sound absorption is therefore critical when colleagues need to collaborate without becoming a distraction to their neighbors. Interface Hospitality carpets provide high sound absorption and insulation.

Casual Lobby Prototype Order Information

FOR PRICING CONTACT: Kim Fulton kim.fulton@interfacehospitality.com or your local Account Executive

FOR ORDER ENTRY / SHIPPING CONTACT: Customer Service 1.800.634.6032 CustomerSuccess-Hospitality@interface.com



Lobby Product	Hilton Spec. #	Sample #	Color #	Size	Installation
Ground Waves A	C-10 C-1	257617-089	189122	25cm x 1m	Herringbone
Ground Waves B	C-10 C-2	257617-091	189108	25cm x 1m	Herringbone
Installation Specifications	Description				
XL2000 Plus	Adhesive				
CushionBac Renew	Pad				

LOBBY INSTALLATION PLAN

Interface Hospitality

All quantities are estimates only and are based on plans provided. Site measurements and field verifications are recommended to ensure accuracy. These quantities are not intended to be used for material ordering purposes. Since waste factors may vary by installer, actual ordering quantities are the responsibility of your flooring contractor.

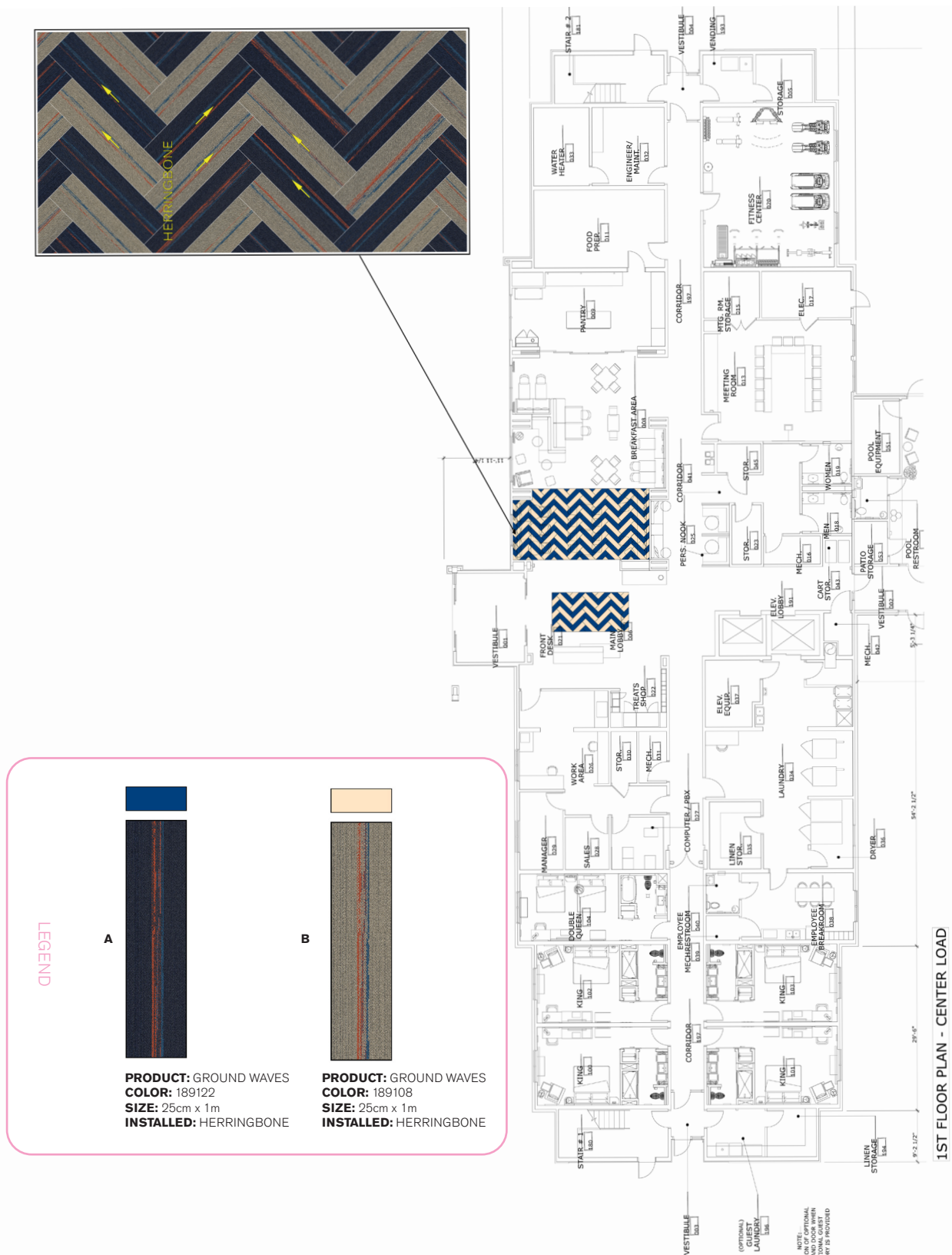

Casual Corridor Prototype Order Information

FOR PRICING CONTACT: Kim Fulton kim.fulton@interfacehospitality.com or your local Account Executive

FOR ORDER ENTRY / SHIPPING CONTACT: Customer Service 1.800.634.6032 CustomerSuccess-Hospitality@interface.com

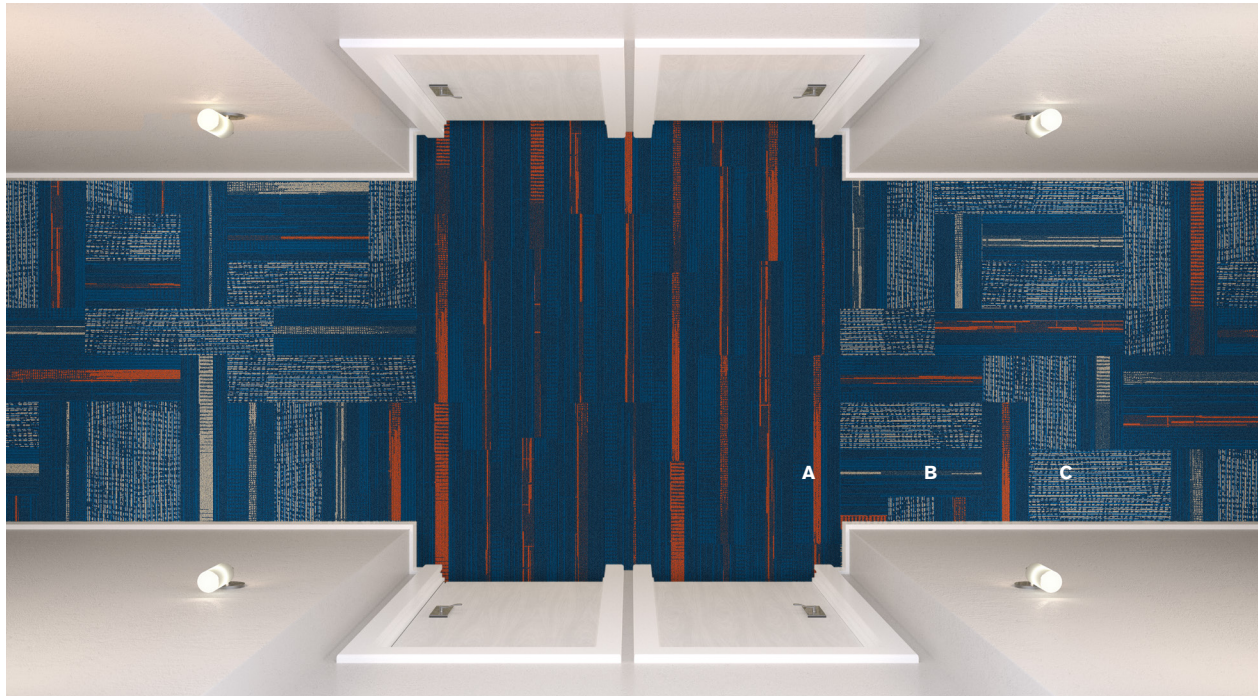

Corridor Products	Hilton Spec. #	Sample #	Color #	Size	Installation
Trio A	C-11 C-1	268431-020	189113	25cm x 1m	Ashlar
Trio B	C-11 C-2	268431-021	189112	25cm x 1m	Pattern by Tile
GN160 C	C-11 C-3	268431-022	189111	25cm x 1m	Pattern by Tile
Stair Products	Hilton Spec. #	Sample #	Color #	Backing	Description
GN160		268431-022	189111	Glasbac	Stair Landing
GN160		268431-022	189111	Unbacked Sheet Goods	Stair Carpet
Installation Specifications	Description				
CushionBac Renew	Pad				
XL2000 Plus	Adhesive used with CushionBac Renew				

CORRIDOR INSTALLATION PLAN

Interface Hospitality

All quantities are estimates only and are based on plans provided. Site measurements and field verifications are recommended to ensure accuracy. These quantities are not intended to be used for material ordering purposes. Since waste factors may vary by installer, actual ordering quantities are the responsibility of your flooring contractor.

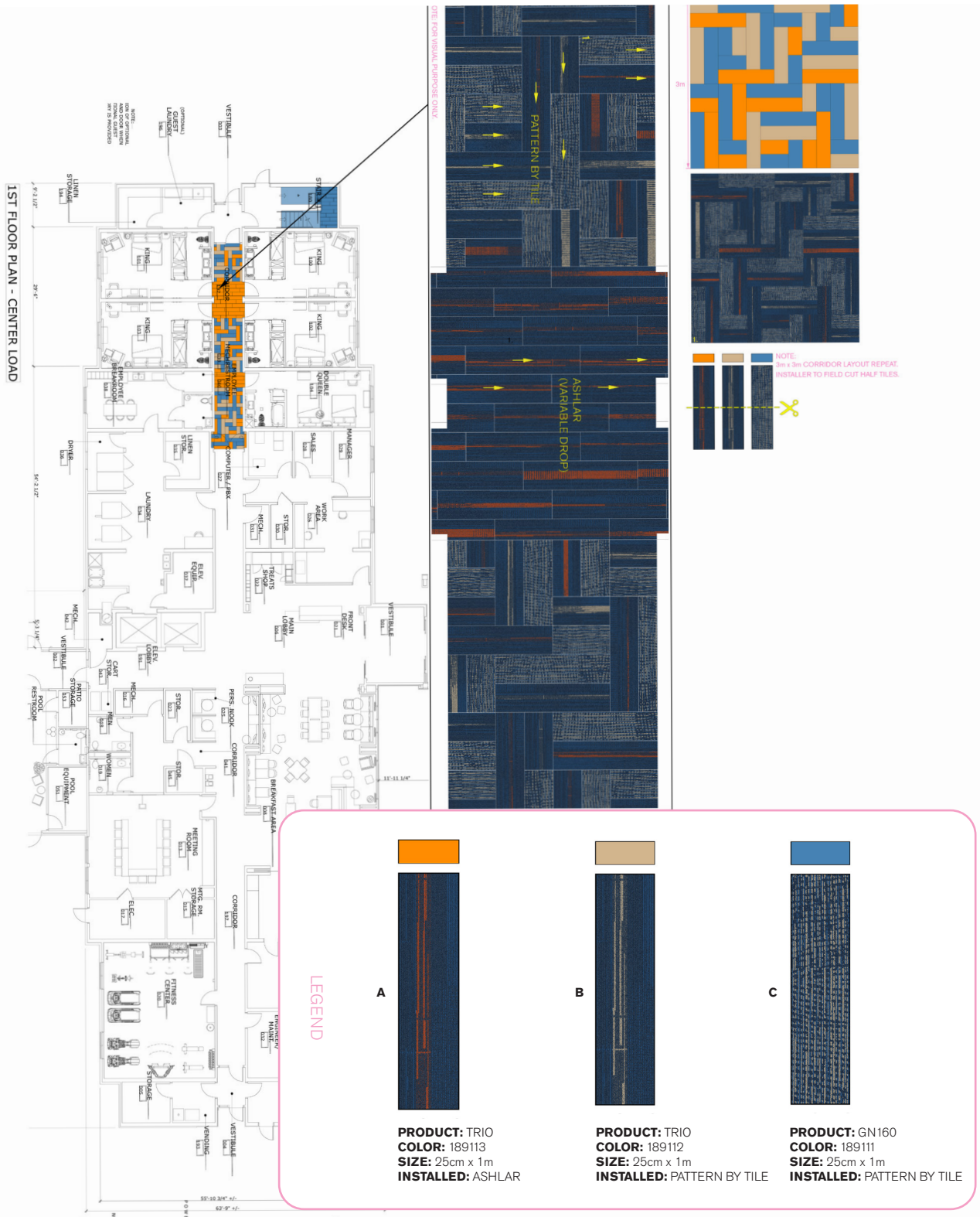

Casual Guest Room Prototype Order Information

FOR PRICING CONTACT: Kim Fulton kim.fulton@interfacehospitality.com or your local Account Executive

FOR ORDER ENTRY / SHIPPING CONTACT: Customer Service 1.800.634.6032 CustomerSuccess-Hospitality@interface.com



Guest Room Product	Hilton Spec. #	Sample#	Color #	Size	Installation
Main Line	C-01 C	268431-033	189109	50cm x 50cm	Brick
Installation Specifications	Description				
XL2000 Plus	Adhesive				
CushionBac Renew	Pad				

GUEST ROOM INSTALLATION PLAN

Interface Hospitality

All quantities are estimates only and are based on plans provided. Site measurements and field verifications are recommended to ensure accuracy. These quantities are not intended to be used for material ordering purposes. Since waste factors may vary by installer, actual ordering quantities are the responsibility of your flooring contractor.



Casual Meeting Room Prototype Order Information

FOR PRICING CONTACT: Kim Fulton kim.fulton@interfacehospitality.com or your local Account Executive

FOR ORDER ENTRY / SHIPPING CONTACT: Customer Service 1.800.634.6032 CustomerSuccess-Hospitality@interface.com



Meeting Room Product	Hilton Spec. #	Sample#	Color #	Size	Installation
Ground Waves	C-12 C	257617-089	189122	25cm x 1m	Quarter Turn
Installation Specifications	Description				
XL2000 Plus	Adhesive				
CushionBac Renew	Pad				

GUEST ROOM INSTALLATION PLAN

Interface Hospitality

All quantities are estimates only and are based on plans provided. Site measurements and field verifications are recommended to ensure accuracy. These quantities are not intended to be used for material ordering purposes. Since waste factors may vary by installer, actual ordering quantities are the responsibility of your flooring contractor.



Casual Office Prototype Order Information

FOR PRICING CONTACT: Kim Fulton kim.fulton@interfacehospitality.com or your local Account Executive

FOR ORDER ENTRY / SHIPPING CONTACT: Customer Service 1.800.634.6032 CustomerSuccess-Hospitality@interface.com



Office Product	Hilton Spec. #	Sample#	Color #	Size	Installation
Ground Waves	C-13 C	257617-089	189122	25cm x 1m	Ashlar
Installation Specifications	Description				
XL2000 Plus	Adhesive				
CushionBac Renew	Pad				

OFFICE INSTALLATION PLAN

Interface Hospitality

All quantities are estimates only and are based on plans provided. Site measurements and field verifications are recommended to ensure accuracy. These quantities are not intended to be used for material ordering purposes. Since waste factors may vary by installer, actual ordering quantities are the responsibility of your flooring contractor.



Casual Break Room Prototype Order Information

FOR PRICING CONTACT: Kim Fulton kim.fulton@interfacehospitality.com or your local Account Executive

FOR ORDER ENTRY / SHIPPING CONTACT: Customer Service 1.800.634.6032 CustomerSuccess-Hospitality@interface.com



Break Room Product	Hilton Spec. #	Color #	Size	Installation
Natural Woodgrains LVT	LVT-15 C	A00204 Beech	25cm x 1m	Ashlar
Installation Specifications	Description			
XL2000 Plus	Adhesive			

Interface® Hospitality

[illegible]

Confident Lobby Prototype Order Information

FOR PRICING CONTACT: Kim Fulton kim.fulton@interfacehospitality.com or your local Account Executive

FOR ORDER ENTRY / SHIPPING CONTACT: Customer Service 1.800.634.6032 CustomerSuccess-Hospitality@interface.com



Lobby Product	Hilton Spec. #	Sample#	Color #	Size	Installation
AE312	C-10 C	268431-039	189114	50cm x 50cm	Quarter Turn
Installation Specifications	Description				
XL2000 Plus	Adhesive				
CushionBac Renew	Pad				

Interface® Hospitality

1ST FLOOR PLAN - CENTER LOAD

LEGEND

- PRODUCT:** AE312
- COLOR:** 189114
- SIZE:** 50cm
- INSTALLED:** Quartz

LEGEND

A

PRODUCT: AE312
COLOR: 189114
SIZE: 50cm
INSTALLED: Quarter Turn

Confident Corridor Prototype Order Information

FOR PRICING CONTACT: Kim Fulton kim.fulton@interfacehospitality.com or your local Account Executive

FOR ORDER ENTRY / SHIPPING CONTACT: Customer Service 1.800.634.6032 CustomerSuccess-Hospitality@interface.com

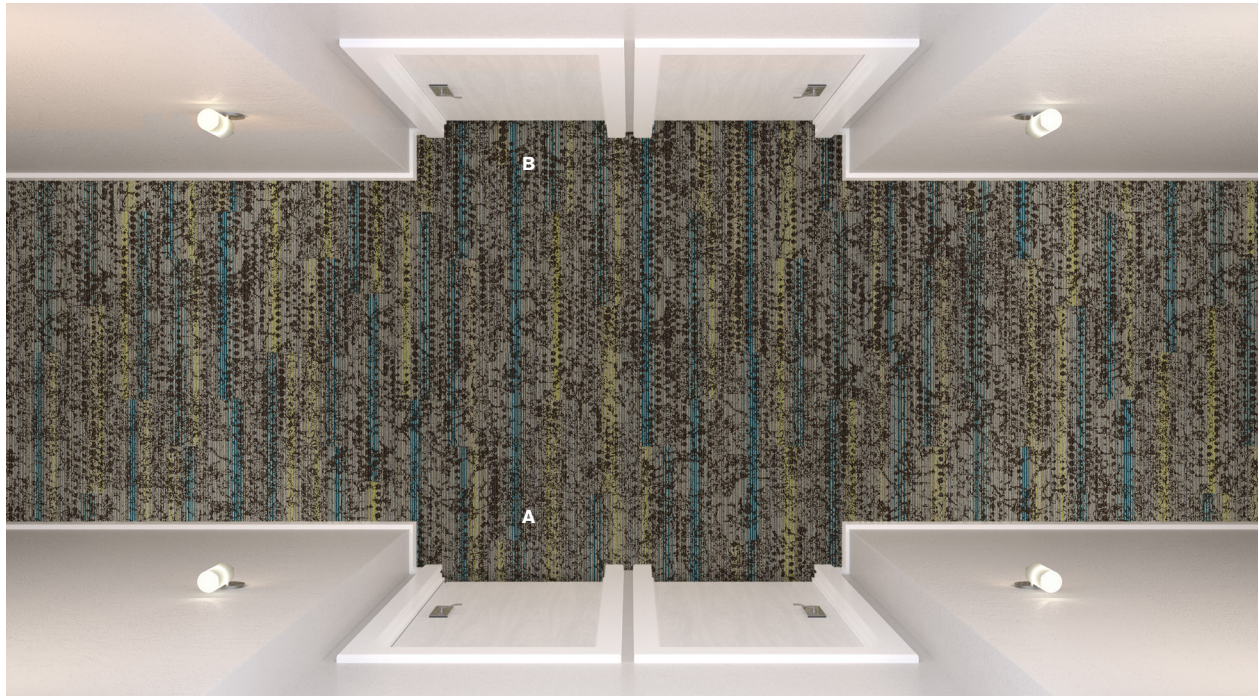

Corridor Product	Hilton Spec. #	Sample#	Color #	Size	Installation
Custom	C-11 C-1	268458-055	189121	25cm x 1m	Ashlar
Custom	C-11 C-2	268458-056	189120	25cm x 1m	Ashlar
Installation Specifications	Description				
XL2000 Plus	Adhesive				
CushionBac Renew	Pad				

CORRIDOR INSTALLATION PLAN

Interface Hospitality

All quantities are estimates only and are based on plans provided. Site measurements and field verifications are recommended to ensure accuracy. These quantities are not intended to be used for material ordering purposes. Since waste factors may vary by installer, actual ordering quantities are the responsibility of your flooring contractor.

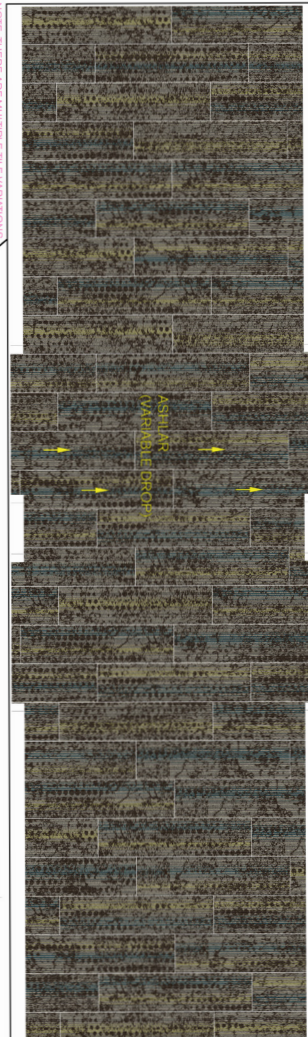

LEGEND

A

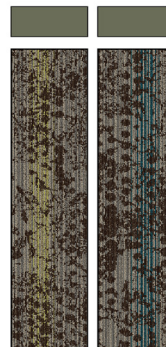

PRODUCT: CUSTOM
COLOR: 189121
SIZE: 25cm x 1m
INSTALLED: ASHLAR
* There are multiple tile variations within a box.

B

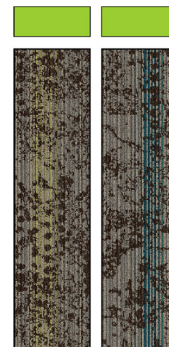

PRODUCT: CUSTOM
COLOR: 189120
SIZE: 25cm x 1m
INSTALLED: ASHLAR
* There are multiple tile variations within a box.

Confident Guest Room Prototype Order Information

FOR PRICING CONTACT: Kim Fulton kim.fulton@interfacehospitality.com or your local Account Executive

FOR ORDER ENTRY / SHIPPING CONTACT: Customer Service 1.800.634.6032 CustomerSuccess-Hospitality@interface.com



Guest Room Product	Hilton Spec. #	Color #	Sample#	Size	Installation
Main Line	C-01 C	189110	268458-052	50cm x 50cm	Brick
Installation Specifications	Description				
XL2000 Plus	Adhesive				
CushionBac Renew	Pad				

GUEST ROOM INSTALLATION PLAN

Interface® Hospitality

All quantities are estimates only and are based on plans provided. Site measurements and field verifications are recommended to ensure accuracy. These quantities are not intended to be used for material ordering purposes. Since waste factors may vary by installer, actual ordering quantities are the responsibility of your flooring contractor.



Confident Meeting Room Prototype Order Information

FOR PRICING CONTACT: Kim Fulton kim.fulton@interfacehospitality.com or your local Account Executive

FOR ORDER ENTRY / SHIPPING CONTACT: Customer Service 1.800.634.6032 CustomerSuccess-Hospitality@interface.com



Meeting Room Product	Hilton Spec. #	Sample#	Color #	Size	Installation
Custom	C-12 C-1	268458-055	189121	25cm x 1m	Quarter Turn
Custom	C-12 C-2	268458-056	189120	25cm x 1m	Quarter Turn
Installation Specifications	Description				
XL2000 Plus	Adhesive				
CushionBac Renew	Pad				

MEETING ROOM INSTALLATION PLAN

Interface Hospitality

All quantities are estimates only and are based on plans provided. Site measurements and field verifications are recommended to ensure accuracy. These quantities are not intended to be used for material ordering purposes. Since waste factors may vary by installer, actual ordering quantities are the responsibility of your flooring contractor.

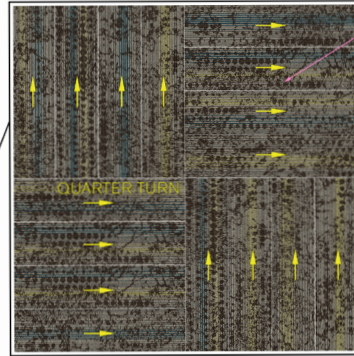

NOTE: THERE ARE MULTIPLE TILE VARIATIONS WITHIN BOX COLORS #189120 & 189121. *SEE LEGEND FOR EXAMPLES.

LEGEND

A

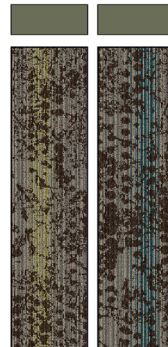

PRODUCT: CUSTOM
COLOR: 189121
SIZE: 25cm x 1m
INSTALLED: QUARTER TURN
* There are multiple tile variations within a box.

B

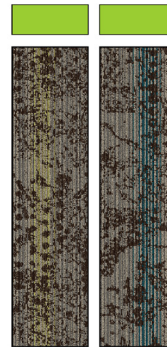

PRODUCT: CUSTOM
COLOR: 189120
SIZE: 25cm x 1m
INSTALLED: QUARTER TURN
* There are multiple tile variations within a box.

Confident Office Prototype Order Information

FOR PRICING CONTACT: Kim Fulton kim.fulton@interfacehospitality.com or your local Account Executive

FOR ORDER ENTRY / SHIPPING CONTACT: Customer Service 1.800.634.6032 CustomerSuccess-Hospitality@interface.com



Office Product	Hilton Spec. #	Sample#	Color #	Size	Installation
AE312	C-13 C	268431-039	189114	50cm x 50cm	Quarter Turn
Installation Specifications		Description			
XL2000 Plus		Adhesive			
CushionBac Renew		Pad			

OFFICE INSTALLATION PLAN

Interface Hospitality

All quantities are estimates only and are based on plans provided. Site measurements and field verifications are recommended to ensure accuracy. These quantities are not intended to be used for material ordering purposes. Since waste factors may vary by installer, actual ordering quantities are the responsibility of your flooring contractor.

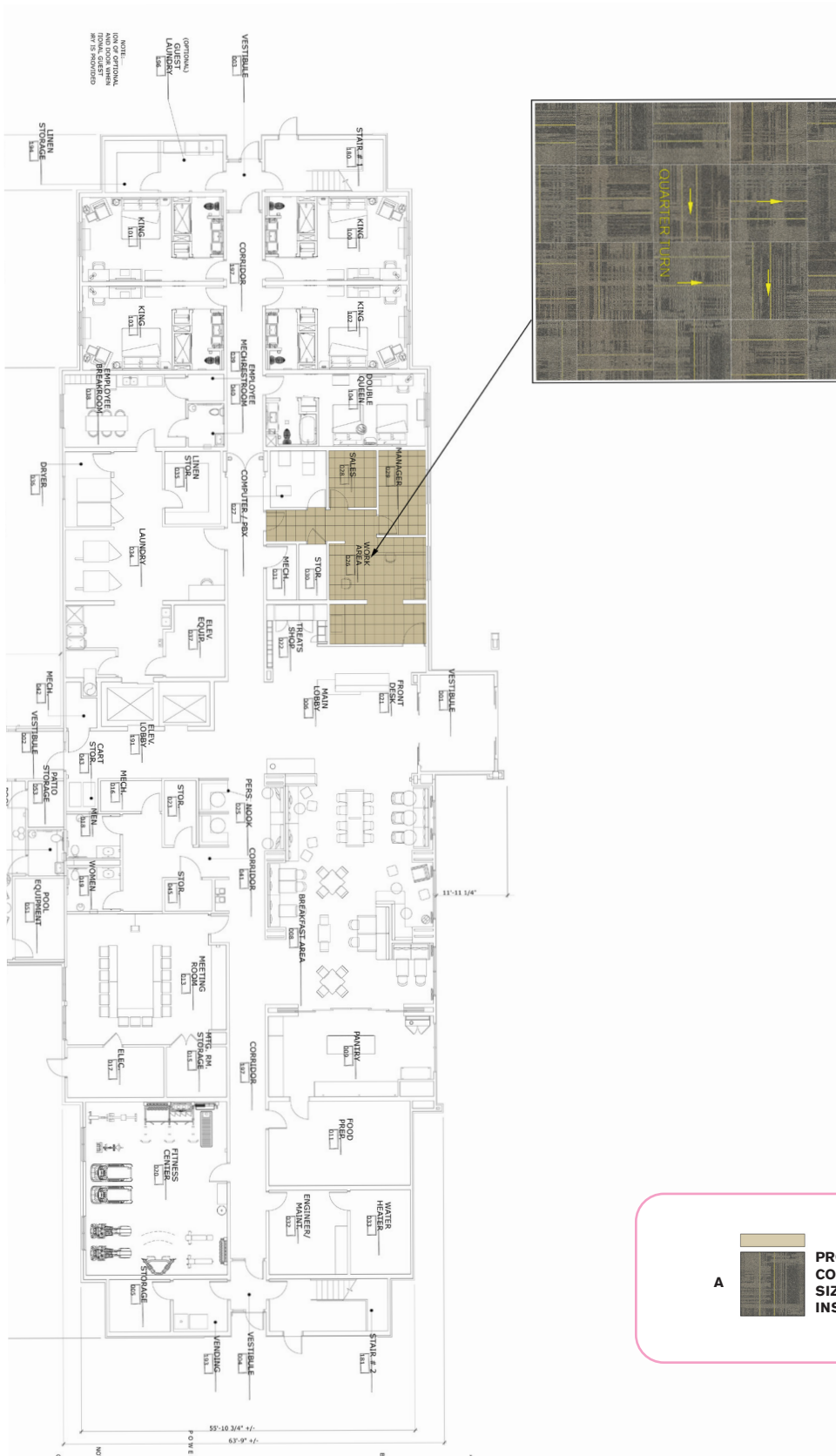

A



PRODUCT: AE312
COLOR: 189114
SIZE: 50cm
INSTALLED: QUARTER TURN

Confident Break Room Prototype Order Information

FOR PRICING CONTACT: Kim Fulton kim.fulton@interfacehospitality.com or your local Account Executive

FOR ORDER ENTRY / SHIPPING CONTACT: Customer Service 1.800.634.6032 CustomerSuccess-Hospitality@interface.com



Break Room Product	Hilton Spec. #	Color #	Size	Installation
Natural Woodgrains LVT	LVT-15	A00204 Beech	25cm x 1m	Ashlar
Installation Specifications	Description			
XL2000 Plus	Adhesive			

Interface® Hospitality

1ST FLOOR PLAN - CENTER LOAD

ASHLAR
(VARIABLE DROP)

LEGEND

A

PRODUCT: NATURAL WOODGRAINS
COLOR: A00204 BEECH
SIZE: 25cm x 1m
INSTALLED: ASHLAR

